



10, Weymouth Street,  
, W1W

£1,800 Per Week,

NAPIER WATT

T: 0207 935 0011  
E: [enquiries@napierwatt.co.uk](mailto:enquiries@napierwatt.co.uk)  
W: [napierwatt.co.uk](http://napierwatt.co.uk)

35 Berkeley Square, Mayfair, London, W1J 5BF







## Description

A spacious three double bedroom, two bathroom apartment to rent in the heart of Marylebone W1 located in an impressive building with 24 hour porter, lifts and balcony to the front.

This block is a 5-minute walk from Marylebone High Street, Oxford Street and Regents Park.

The Property has amazing transport links with the property being suited moments' walk away from Regents Park Tube Station. (Bakerloo Line) and Great Portland Tube Station (Circle Line, Hammersmith & City Line and Metropolitan Line.

The apartment is in good decorative condition and ready for Long Let from 7TH August

Parking available separately to rent.

## Key Features

- 24 HOUR PORTER
- BALCONY
- FOURTH FLOOR
- LIFTS
- GOOD CONDITION
- PARKING AVAILABLE BY SEP NEG

## Terms

Fees & Charges: Tenancies exceeding £100,000 Per annum £480 inc VAT, Tenancies where a company is a tenant £480 Inc VAT.

Parking is available by separate negotiation

## Weymouth Street

Approx. Gross Internal Area  
1193.0 Ft<sup>2</sup> - 110.0 M<sup>2</sup>

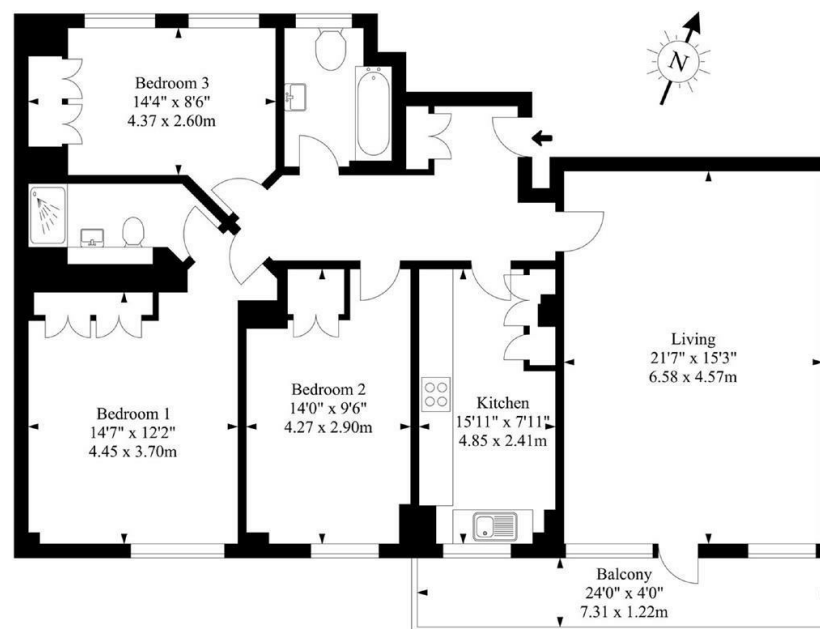

## Second Floor

Illustration For Identification Purposes Only. Not To Scale

IMPORTANT: We would inform prospective purchasers that these sales particulars have been prepared as a general guide only. A detailed survey has not been carried out, nor the services, appliances and fittings tested. Room sizes should not be relied upon for furnishing purposes and are approximate. If floor plans are included, they are for guidance only and illustration purposes only and may not be to scale. If there are any important matters likely to affect your decision to buy, please contact us before viewing the property.